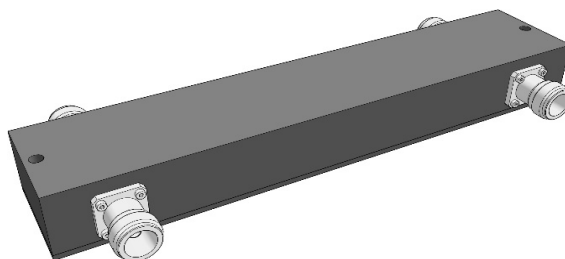

**3dB Hybrid Coupler,300-960MHz,NF****Specifications**

General Specification	
Application	Indoor/Outdoor
Color	Black
Inner Contact Plating	Silver
Interface	N female
Outer Contact Plating	Tri metal
Housing	Passivated Aluminum or powder paint
Dimensions	
Length*Width*Height	203 mm * 76 mm * 25 mm
Weights	
Weight, net	0.61 kg
Electrical Specification	
Power Rating , Max	120 W avg.
Impedance, nominal	50 ohm
Frequency Range	300-960 MHz
VSWR, Max	1.2, All Ports
Coupling	3.1 ± 0.2 dB
Frequency Sensitivity	± 0.3 dB
Input Isolation, Min	23 dB
Insertion Loss, Max	0.2 dB
DC Capability	DC transmission only between cross ports

3dB Hybrid Coupler,300-960MHz,NF

Environmental Specification

Temperature Range	-25 °C to +75 °C
Ingress Protection Test Method	IP65
Regulatory Compliance	
ROHS	Compliant